



Laundry

COLLECTION *by Newtech*

INSTALLATION INSTRUCTIONS PRODUCT CARE INFORMATION & WARRANTY

Preparation	2-3
Installation Instructions	4-8
Door Adjustments	9
Drawer Adjustments	10-11
Care & Maintenance	12
Newtech Warranty	13

IMPORTANT

Thank you for purchasing from our Laundry Collection.

NEWTECH RECOMMENDS THAT A QUALIFIED TRADESPERSON INSTALL THIS PRODUCT AND THAT IT IS INSTALLED TO A **PROFESSIONAL STANDARD**. This product carries a full warranty against faulty **workmanship and materials**. Please inspect for damage before installation. It is the responsibility of the installer to **make any adjustments** to doors/drawers after installation if required.

Preparation - Prior to installation



IMPORTANT - Newtech recommends that a qualified tradesperson install this product and that it is installed to a **professional standard**. This product carries a full warranty against faulty **workmanship and materials**. Please inspect for damage before installation. It is the responsibility of the installer to **make any adjustments** to doors/drawers after installation if required.

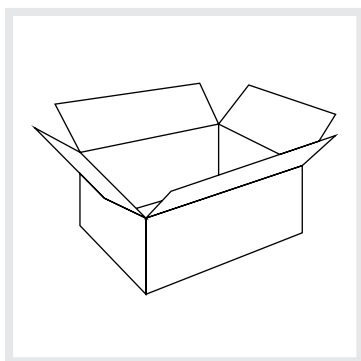

1. CHECK PRODUCTS FOR ANY DAMAGES

Please inspect all products thoroughly before installation to ensure that the products have not been damaged in transit, and that the products are correct. No claims for damage or incorrect items will be processed if installation has begun. We cannot cover warranty for removal or re-installation costs.

All items damaged by freight must be reported within 24 hours, otherwise a claim cannot be raised. A Goods Authority number must be obtained from the Newtech Customer Service Team on 0800 728 662 before any damaged product can be returned. This needs to be attached to the returned product.



2. CHECK SUPPORT BEAMS & NOGS

Locate your stud positions throughout the wall, take note of this so you are aware of these positions when you cover them up with the tall units. All units and cabinets require fixing to support nogs fitted between the studs, to give a solid wall backing.

All cabinets need to be attached to the wall using a minimum of 8 gauge 60mm screws if you have a stud wall.

If your wall is brick or concrete you will need advice from your hardware specialists on the correct fixing methods.

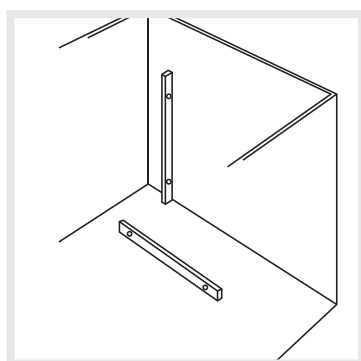

3. ENSURE WALLS ARE PLUMB AND FLOORS ARE LEVEL

Ensure the wall is plumb and straight, ensure floor is level. If you fix the product to a non-plumb wall or floor the following will happen:

- Your door or drawers will not operate correctly
- Door or drawer adjustments will not align.
- Basins will not sit level, which may cause water to pool or not drain correctly

If it is not possible to make the wall or floor plumb and straight you must pack the vanity out so that it does not follow the out of aligned wall.

Floor standing cabinets must sit on a level floor or be packed to sit level and true.

NOTE: We recommend using cabinet connectors to join all adjoining floor and tall cabinets together and all adjoining wall cabinets together before fixing the cabinets to the wall. This will help with easier cabinet installation and overall levelling. Don't forget to adjust the feet on the floor cabinets for easy levelling.

Preparation - Prior to installation

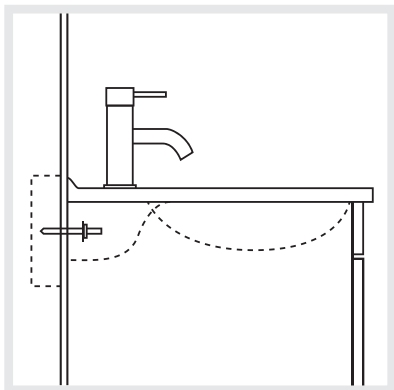

4. CHECK PLUMBING POSITIONS PROPERLY ALIGN

Measure and mark the cabinetry for the location of waste and hot/cold water supply. Drill from the inside of the cabinetry using the appropriately sized holesaw.

Note: If your product has any electrical fittings please allow for this and talk to your electrician.

Important Tips

- Your kickboard height is 150mm, keep this in mind when levelling your tall and floor cabinets
- Regularly check levels throughout installation
- It is the responsibility of the installer to make any adjustments to doors and drawers after installation if required.
- Use the supplied cabinet connectors to join all adjoining floor and tall cabinets together and all adjoining wall cabinets together before fixing the cabinets to the wall. This will help with easier cabinet installation and overall levelling.
- Remove all doors and drawers whilst installing as it will be much easier and you will avoid damaging panels. No damages will be recognised after installation has begun.
- Avoid sliding and/or dragging cabinets - lift or use a trolley where possible.
- A licensed Plumber is required to install sink and tapware.

Installation Guide

STEP 1

Complete your 'Preparation' checklist and identify which end to start your installation from. See below.

STEP 2

Install your floor and tall cabinets. Use the cabinet connectors to join all adjoining cabinets together, level cabinets by adjusting the metal feet and then fasten to the wall. This includes washing machine & dryer surround, end panels/fillers where applicable. See page 5 for instructions.

STEP 3

Install benchtop

STEP 4

Install wall cabinets and end panels/fillers where applicable

STEP 5

Install splashback (if applicable) see page 7.

STEP 6

Install kickboards (see page 8 for instructions).

EXTRAS

Install any extras (hanging rail, LED lights etc)

1. Start your laundry installation

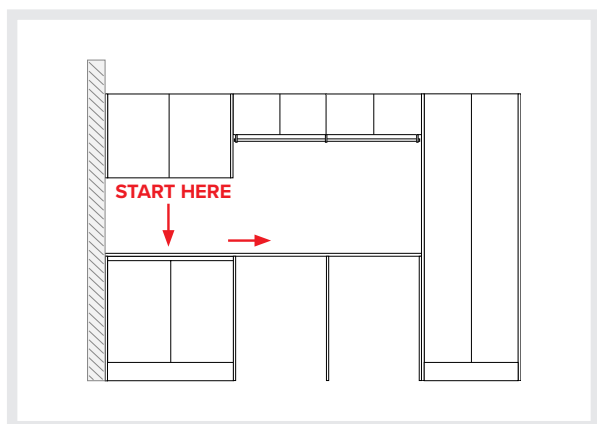

If your laundry is placed in a corner/against wall, start your installation here.

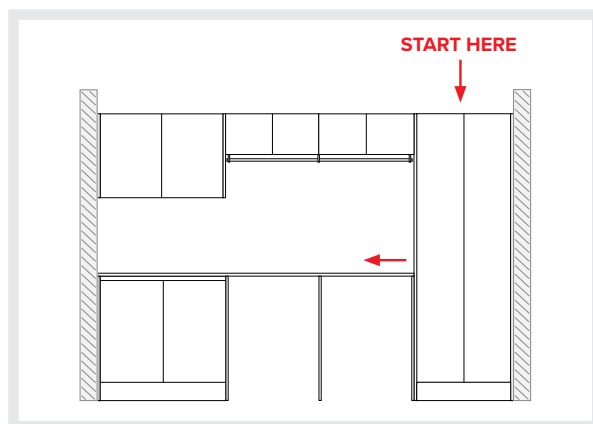

If your laundry is between walls, start the installation from the tall cabinet. If there is no tall cabinet, start from either side.

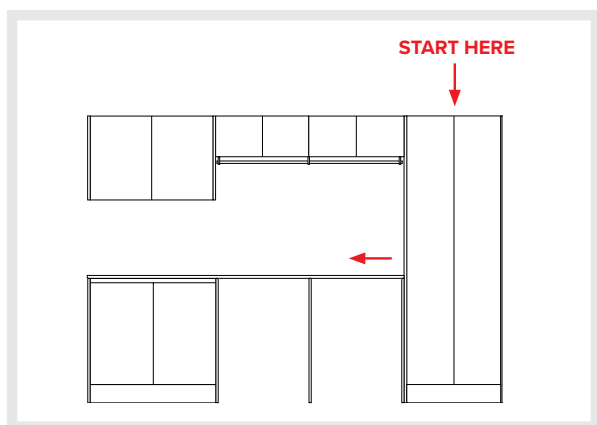

If your laundry is not placed up against a wall start the installation from the tall cabinet. If there is no tall cabinet, start from either side.

Tip: measure the total space first to ensure your fillers are even on either side.

2. Tall & Floor Cabinetry Installation

NOTE: ATTACH METAL ADJUSTABLE FEET

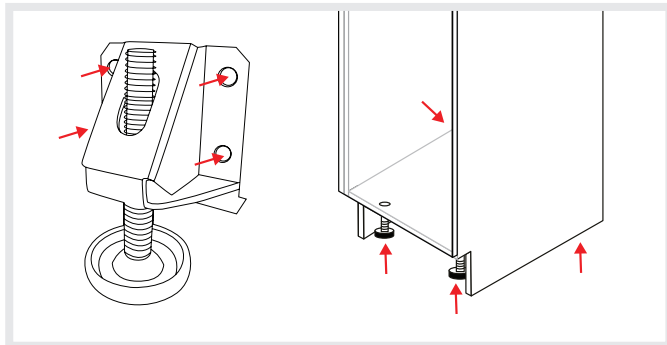

Attach the metal adjustable feet (supplied) to your cabinet. Fasten the feet to the bottom of the cabinet through the pre-drilled holes - 2 at the front and 2 at the back.

1. MEASURE & POSITION

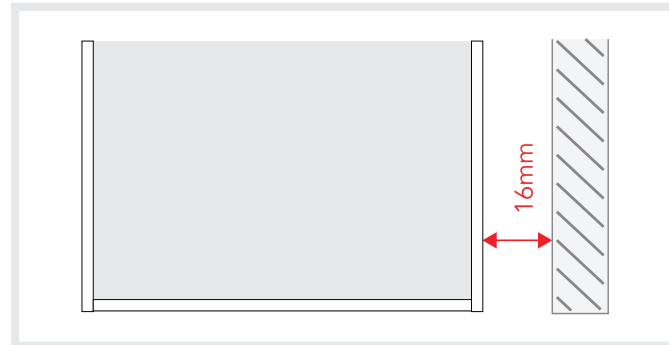

Measure and place cabinets in position. If against a wall - Place cabinet 16mm away from your starting wall (to allow for the filler strip).

Note - If going in between walls, your filler gaps should be evenly spaced. If this filler gap is larger than 16mm, use the end panel face side.

2. JOIN TALL CABINETS TOGETHER

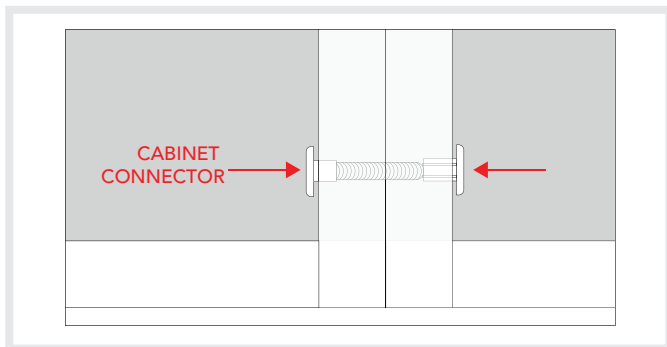

If you have two or more adjoining tall/floor cabinets you will need to join these together.

1. Place cabinet in position next to the first cabinet.
2. Using cabinet connectors (supplied) join the cabinets together through each of the pre-drilled holes.
3. Be sure to install end panels, and washing machine surround if required (see page 8 for assembly instructions).

3. LEVEL & ADJUST

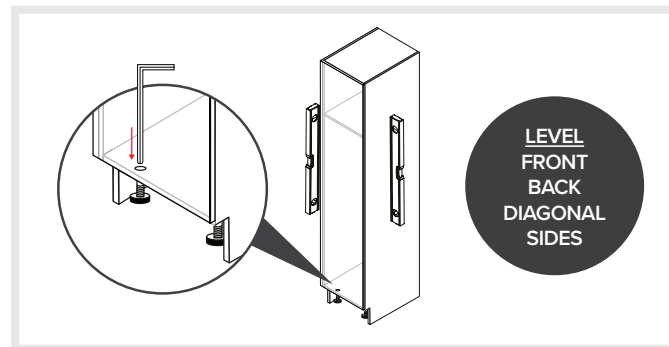

Check cabinets are level in all directions and adjust if needed. Use the supplied allen key to adjust metal feet - insert through top of base panel in cabinet into the legs. Turn to lift or lower legs until cabinet(s) are level in all directions.

Keep in mind the kickboard is 150mm high so don't go too low or high.

4. LOCATE PLUMBING & DRILL HOLES

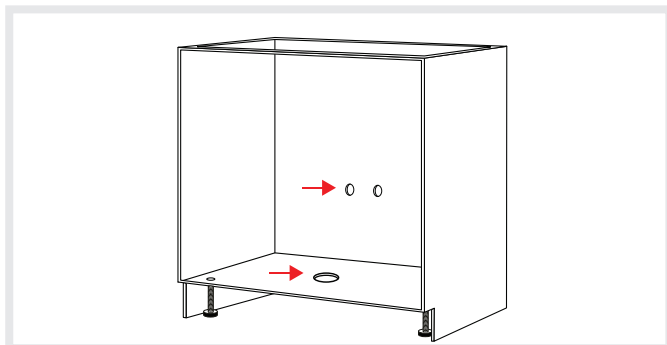

Locate plumbing and drill appropriate sized hole in base and back panel of cabinet for services.

5. FASTEN CABINETS TO WALL

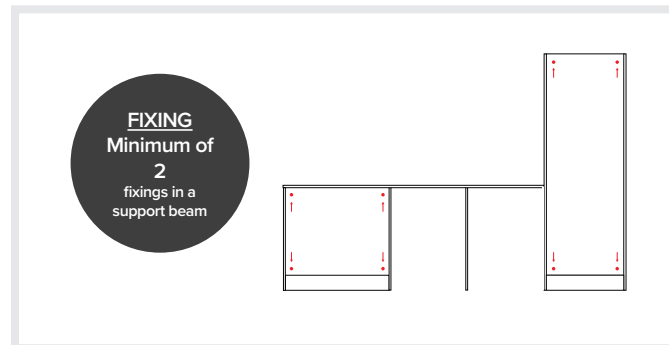

Once all cabinets are level and adjoined, fasten to wall.

1. Mark stud positions.
2. With 5mm drill bit, pre-drill through back of cabinet into stud.
3. Fasten cabinet to back of wall with appropriate screws/ bolts. It is recommended to fasten at the top and bottom of the cabinet.

Note: Where a stud or support beam cannot be located, use an appropriately sized hollow wall anchor. Cabinet must attach to a minimum of 1 stud with 2 fixings.

2. Tall & Floor Cabinetry Installation continued ...

7. ASSEMBLE WASHING MACHINE SURROUND

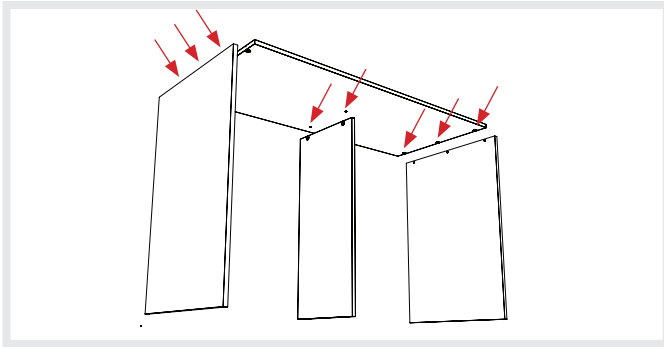

The Washing Machine and Dryer surround will come flatpacked. Assemble using the cam-locks provided by joining side panels to top panel. Join middle support panel if applicable (double surrounds only).

8. POSITION AND FASTEN

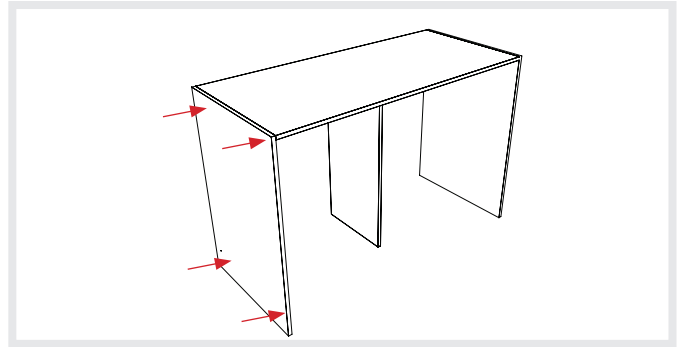

Once assembled, position next to floor/tall cabinet and fasten with 28mm Hospa screw (provided) to adjoining cabinets.

NOTE: FILLER / END PANELS

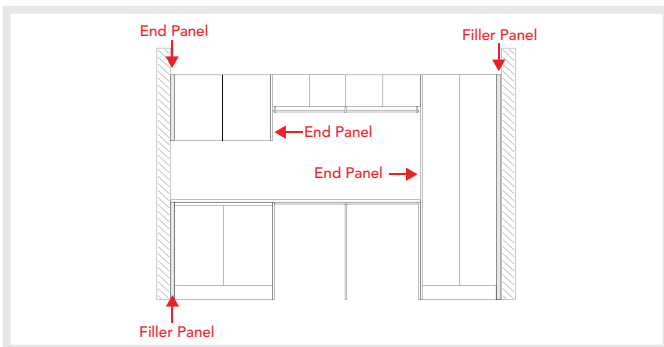

Install filler and/or end panel(s) throughout installation where applicable. See page 8 for instructions.

FINISHING TOUCHES

Use the cover caps provided to cover the screw holes.

3. Benchtop Installation

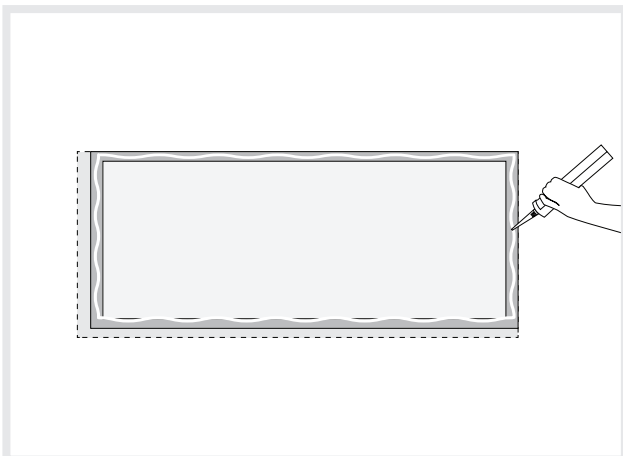

Apply non-acidic silicone to top edges of floor cabinets. With the help of someone else, lift benchtop in place. Ensure the top has overhang (where needed) and is level. Seal all edges with a non-acidic silicone.

Note: Allow to set for 24hrs before continuing

**LICENSED
PLUMBER IS TO
INSTALL
SINK & TAP**

NOTE
FOR ALL UNDERMOUNT
SINKS YOU MUST USE
SINK CLIPS & SILICONE

4. Wall Cabinetry Installation

Note: If you have ordered open shelves or metal frame open shelves, these will already be joined to your wall cabinets

1. JOIN CABINETS TOGETHER

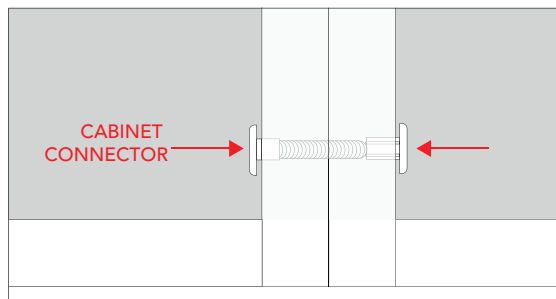

If you have two or more adjoining wall cabinets you will need to join these together before fastening to the wall.

1. Place adjoining cabinets together.
2. Using cabinet connectors (supplied) join the cabinets together through each of the pre-drilled holes.

2. POSITION AND LEVEL

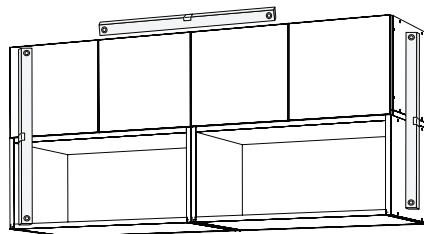

1. With the help of someone else, lift wall cabinets and place in position. You may want to use cabinet stands to help.
2. Check levels.

Note - If going in between walls, your filler gaps should be evenly spaced. If this filler gap is larger than 16mm, use the end panel face side.

3. FASTEN CABINETS TO THE WALL

FIXING
Minimum of
2
fixings in a
support beam

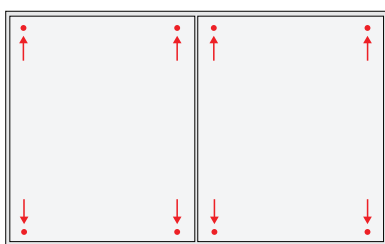

1. Mark stud positions.
2. With 5mm drill bit, pre-drill through back of cabinet into stud.
3. Fasten cabinet to back of wall with appropriate screws/ bolts. It is recommended to fasten at the top and bottom of the cabinet.

Note: Where a stud or support beam cannot be located, use an appropriately sized hollow wall anchor. Cabinet must attach to a minimum of one support beam with two fixings.

NOTE: END PANELS

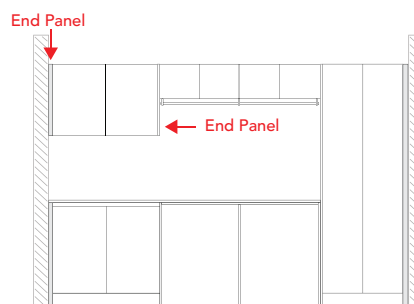

Install end panel(s) throughout installation where applicable. See page 8 for instructions. Finishing touches: use the cover caps provided to cover the screw holes.

5. Splashback Installation



If you have a splashback:

Apply non-acidic silicone to the wall area where your splashback is being placed. With the help of someone else, lift splashback in place and the silicone should provide a seal to suction in place. Using the underside of your top cabinets, clamp temporary blocks to hold splashback in correct position whilst allowing it to dry. Seal all edges with a non-acidic silicone.

Note: Allow to set for 24hrs before continuing.

6. Kickboard Installation

1. SILICONE CARCASS ENDS

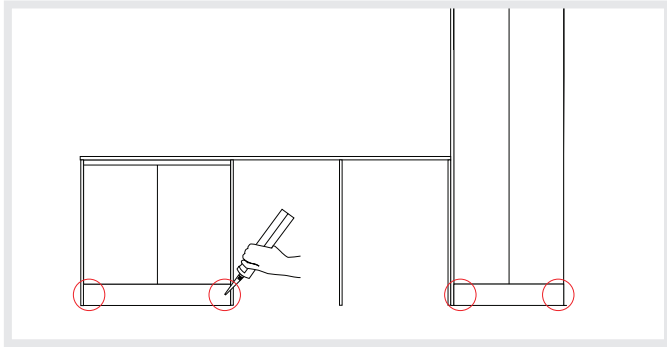

Apply non-acidic silicone to face of carcass ends (where the kickboard will be placed).

2. SECURE KICKBOARD

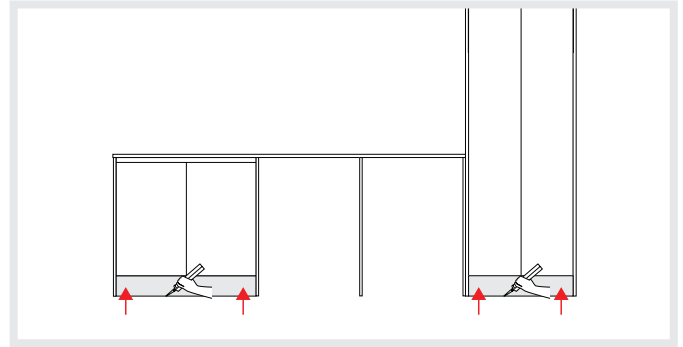

1. Push kickboard firmly in place.
2. Seal kickboard at bottom edge with silicon, to prevent water penetration from occurring. Allow to set for 24hrs.

Note: You may need to plane some material off the kickboard to fit if your floor is uneven.

TIPS - End Panel & Filler Panels

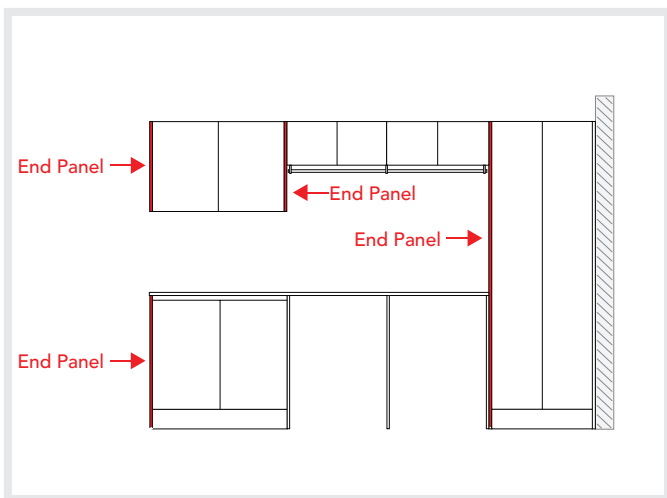

End Panels:

1. Once cabinets are in place and level, attach your end panels to any exposed cabinet ends (use a filler panel if going between cabinet and wall).
2. Hold end panel in place with clamps.
3. Using 28mm Hopsa screws (supplied) join panel by screwing into the pre-drilled holes (make sure you get the front and back holes).

Note

- Ensure all pre-drilled holes are used
- Be mindful to allow extra for push to open doors

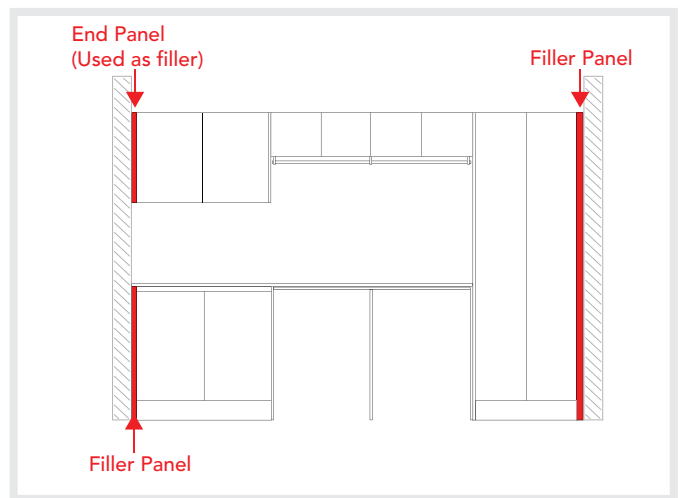

Filler Panels:

1. Between the cabinet and wall, set filler strip.
2. Your filler panel is 100mm x 16mm, so you may need to plane the filler panel to fit/fill depending how big the gap is or due to walls not being plumb.
3. Using 28mm Hopsa screws (supplied), secure filler panel through the pre-drilled holes inside the cabinet.

Note

- Ensure all pre-drilled holes are used
- Be mindful to allow extra for push to open doors

Door Hinge Adjustments

DOOR REMOVAL

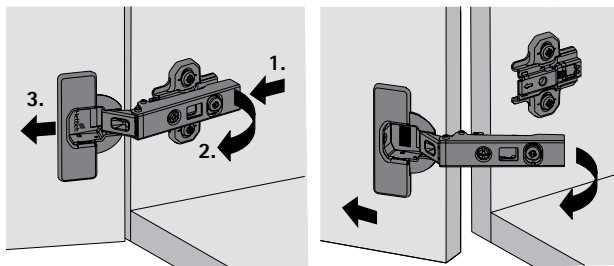

To remove the door hinge lift the catch at back of hinge (1), lift body off hinge plate (2) and slide body of hinge forward (3).

HORIZONTAL ADJUSTMENT

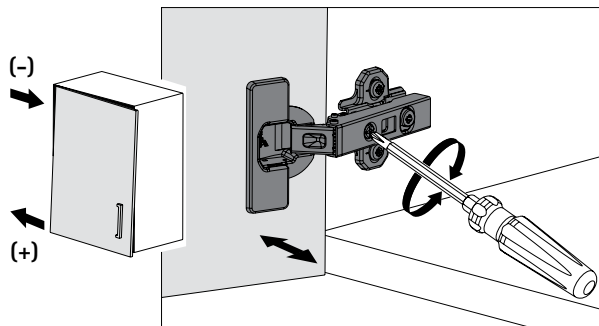

To adjust the door horizontally, using a screwdriver (as pictured) turning clockwise or anti-clockwise until alignment is straight.

HEIGHT ADJUSTMENT

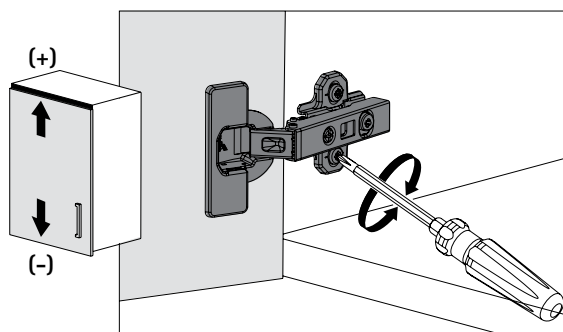

To adjust the height of the door release both hinge plate retaining screws (anti-clockwise), slide hinge plate up or down to correct position and tighten hinge plate retaining screws.

DEPTH ADJUSTMENT

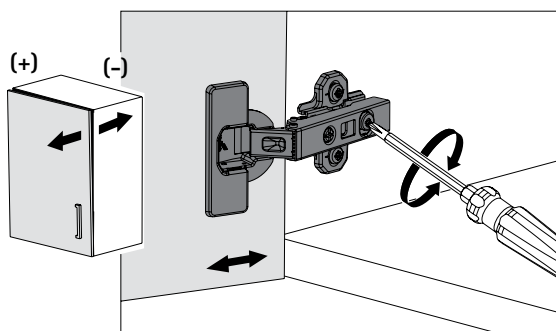

To adjust the gap between the cabinet and door, using a screwdriver (as pictured) turning clockwise or anti-clockwise until alignment is straight.

Drawer Runner Adjustments

DRAWER REMOVAL

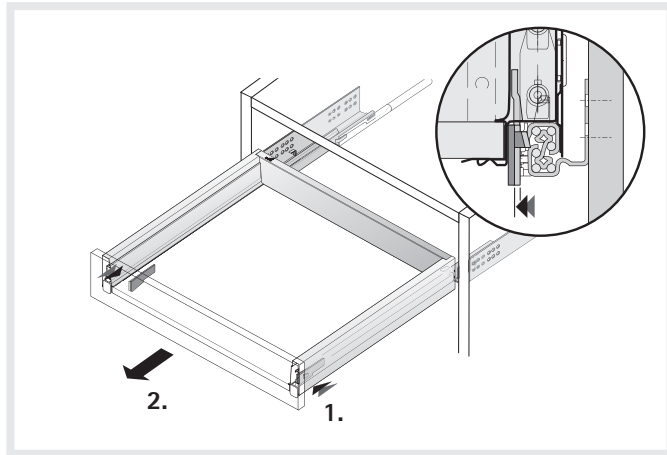

Open the drawer fully. Press the grey levers inwards located under the drawer and pull the drawer forward with both hands place either side of the drawer.

INSERTING DRAWERS

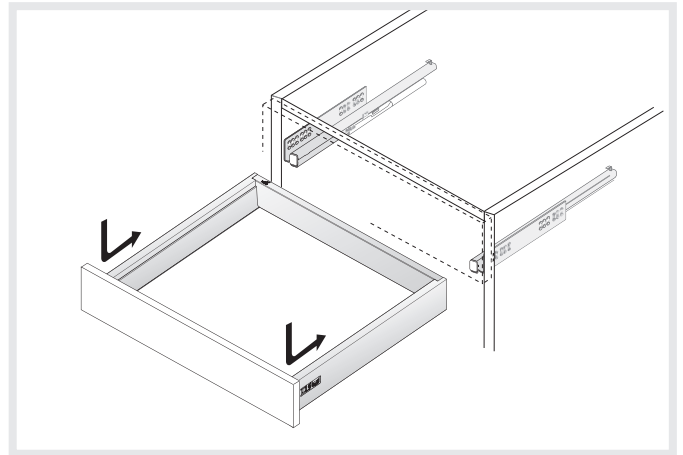

With the drawer runners fully retracted, place the drawer back onto the runners, push closed and listen for a double click and push closed.

INSTALLING & REMOVING COVER CAP

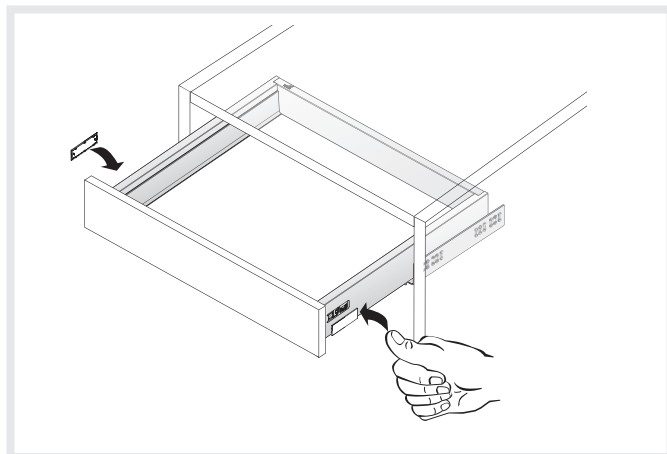

Extend the drawer out and either pull the cap off or push back on.

REMOVING GALLERY RAILS

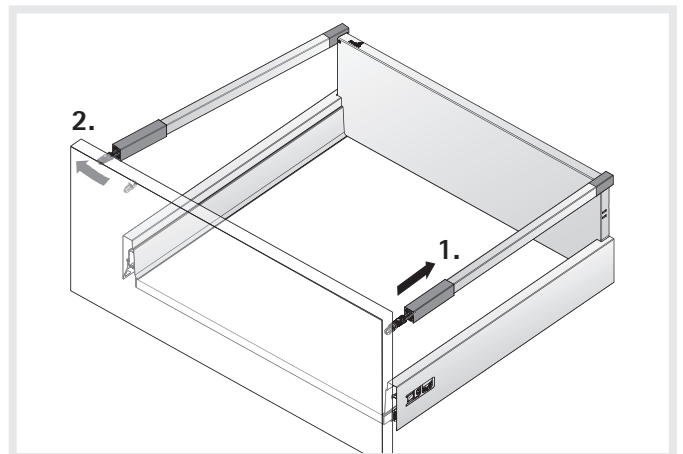

To remove the gallery rails, slide the white tabs (1) towards the back of the drawer, the gallery rail will lift out of front connector.

REMOVING DRAWER FRONT

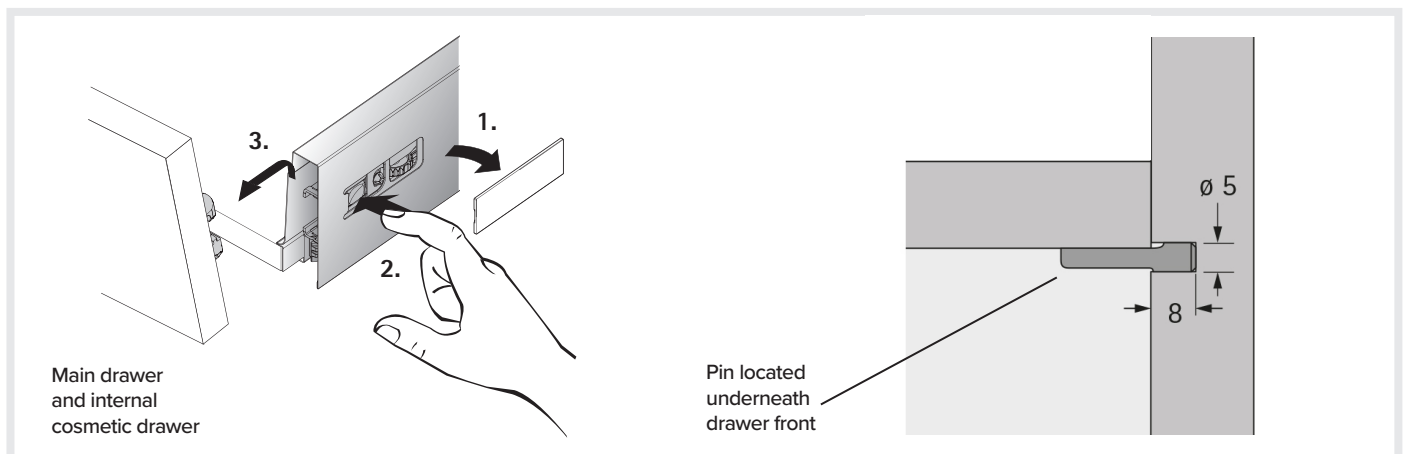

To remove the front panel extend the drawer and remove the cover cap. Disconnect the gallery rails and remove the pin located underneath the drawer front. The pin is removed by pressing lightly on the base of the drawer. Once removed, push the blue button, then the drawer front can be released and lifted out.

NOTE: The drawer runner adjustments apply to all cabinetry drawers excluding the Hamper Drawer.

Drawer Runner Adjustments

ADJUSTING FRONT PANELS (DRAWER FRONTS)

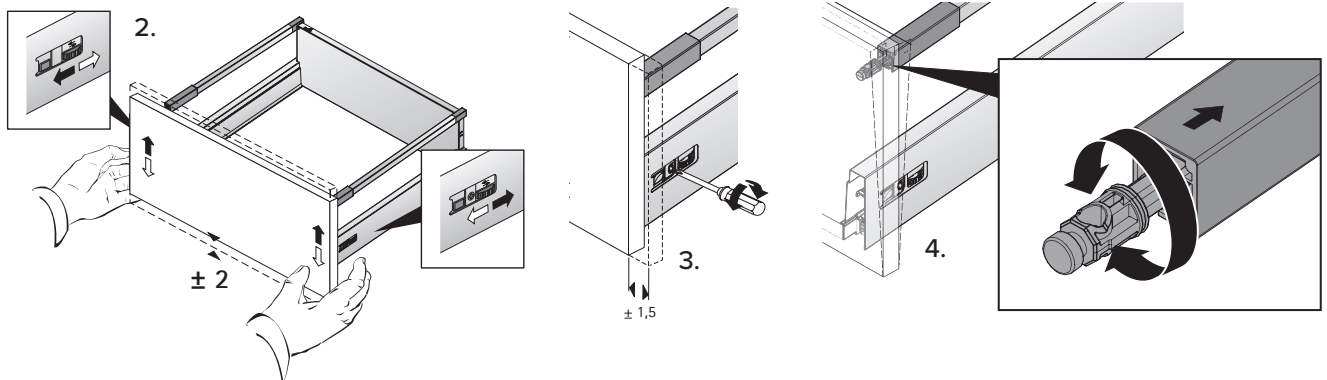

1. Remove the plastic covers on the side. 2. To make adjustments up or down use the little cogged wheels to turn each side as above. 3. To make adjustments left and right use a screwdriver to adjust the screw on the right hand drawer side as above. 4. To make adjustments in and out slide the square gallery rail cover back and use a screwdriver to turn the gallery rail adjuster as above.

Laundry Hamper Drawer Adjustments

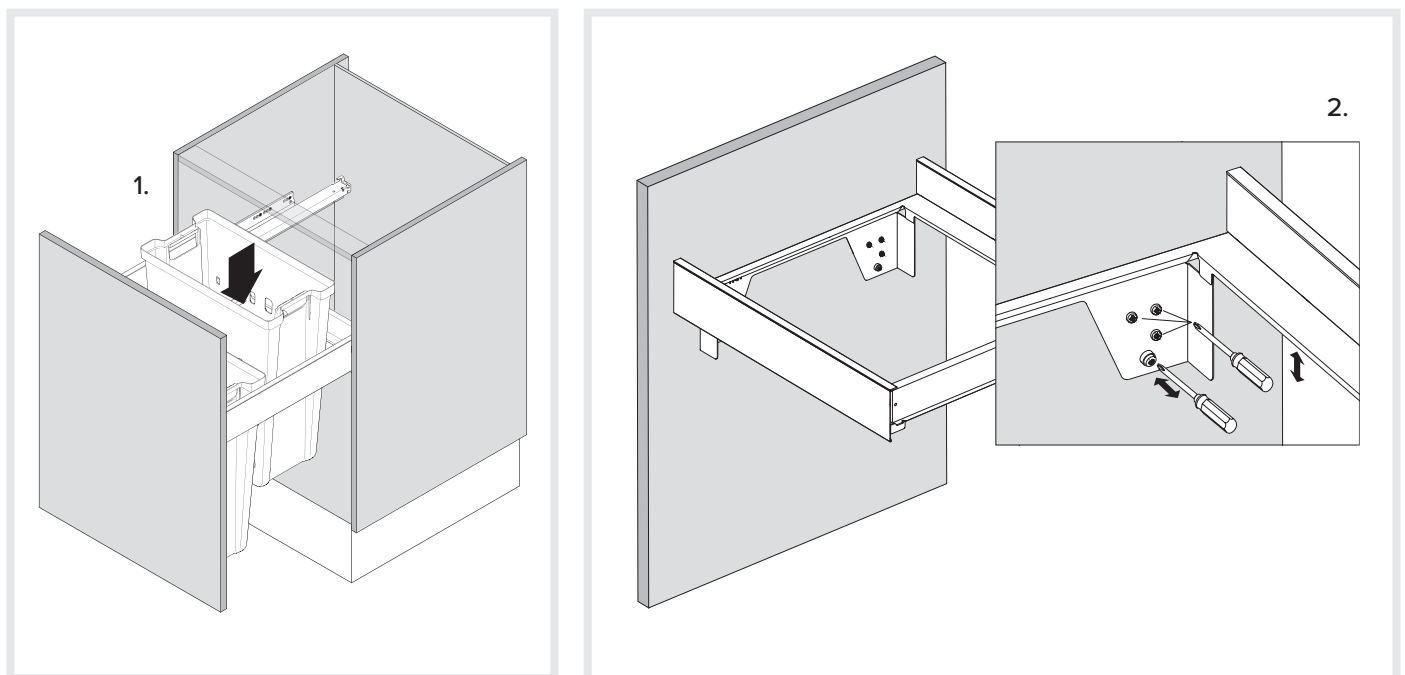

To adjust the Hamper Drawer, locate the three screws (see picture 2), and loosen to unlock drawer front. Locate the plastic screw to alter the tilt adjustment.



Care & Maintenance

TIPS

- Newtech products are produced from materials that are well suited to the laundry, however it is important that your laundry has sufficient ventilation to avoid excessive moisture due to water sources.
 - High humidity will lead to permanent dampness and mould, resulting in deterioration of the materials.
 - Care must always be taken to dry any excessive moisture or water spillage.
-

CABINETS

- To maintain the finish on your cabinetry use only a soft cloth and weak solution of non abrasive detergent.
 - To remove scratches, marks, etc. on two pack polyurethane, rub gently with car cutting compound, car polish or household brass/silver cleaner.
 - Goods used in construction are water/moisture-resistant, but not water-proof
-

QUARTZ SLAB TOPS

- Wipe Your Quartz benchtop with mild dish soap and a soft rag. Take a soft cloth or sponge and dip it in a warm water and soap mix. Take the sponge and begin to gently but firmly wipe down the quartz tops. Wipe them down as often as you need.
-

STAINLESS STEEL SINKS

- Rinse sink with water after use and wipe dry with soft cloth.
- For stubborn stains, we recommend a mild non-scratch cleaner such as a vinegar-based cleaner with a non-abrasive sponge, then rinse well. Clean often to avoid limescale building up.
- DO NOT use steel wool to clean the sink, this will scratch the surface.
- AVOID strong bleaches, silver dip cleaners and aggressive chemicals such as denture cleanser and photo developing liquids. If it occurs, rinse thoroughly and wipe it dry quickly.
- AVOID leaving citrus fruit juice, salt, vinegar, mustard, pickles and mayonnaise on your surface for prolonged periods. These foods can cause pitting and corrosion.

Warranty

This extended warranty only covers Newtech Laundry products, and will not extend to products which have been selected outside our product range. This extended warranty only applies to defects which have arisen solely from faulty materials or workmanship in the products and does not apply to other defects which may have arisen as a result of, without limitation, the following: accidental damage, abuse, misuse, maltreatment, abnormal stress or strain, harsh or adverse weather conditions, including excessive water pressure or temperature, or neglect of any kind.

As per the Building Code Compliance documentation, the maximum temperature sanitary wear can be subjected to is 55C°. Any warranty assessment where the temperature of water for sanitary wear is above 55C° will be declined. The tempering valve must be subject to and comply with NZS4617 or AS1357.

Newtech Laundry products installed in light commercial and or commercial situations are void of the residential warranty and covered for 12 months from date of purchase. Commercial situations are defined as public washrooms, public buildings, schools, sports centres, gymnasiums, hospitals, motels, hotels and retirement villages.

Alterations and repairs of the products performed by someone other than a Newtech pre-approved service person are not covered. For the avoidance of doubt, attachment of accessories or use of non-genuine replacement parts other than those manufactured or approved by Newtech are not covered by this extended warranty.

This extended warranty commences from date of purchase or for new buildings on the date of handover for the relevant period set out in the warranty periods table.

In addition to this extended warranty, certain legislation may give you certain rights which cannot be excluded, restricted or modified. This extended warranty must be read subject to NZ laws, and nothing in this warranty has the effect of excluding, restricting or modifying those rights. Newtech warranty periods are dependent on date of purchase and may be different to what is stated in this publication.

WARRANTY CLAIMS

To make a warranty claim, the following documentation must be emailed or faxed to Newtech (contact details listed below):

- Name/model of product and photographs of the issue (if available)
- Proof of installation (by a licensed plumber) and/or proof of purchase
- Your contact details: name, address and contact phone number
- A copy of handover documentation is required for new homes

Consequential loss to the extent permitted by law; Newtech will not be liable for any loss or damage to furniture, floor coverings, walls, fixtures or any other consequential loss of any kind caused by any defect in the products or components.

Warranty Certificate or equivalent documentation must be supplied for warranty claims to be considered. If the cost of returning any defective parts is unreasonable, please contact Newtech on the telephone number listed below so that, if appropriate, we can arrange a collection. Newtech Bathroomware contact details are as follows:

Newtech Bathroomware

Head Office 281 Heads Road, Wanganui 4501

Auckland Office 525 Great South Road, Penrose, Auckland

Phone 06 349 0194 / 0800 728 662

Email sales@newtech.co.nz

Warranty for Newtech Laundry products are as follows:

PRODUCT	RESIDENTIAL	COMMERCIAL
Wall and Floor Cabinets, Tall Cabinets, Panels	5 years	1 year
Soft Close Drawer Runners	5 years	1 year
Cupboard Drawer Hinges	5 years	1 year
Quartz Benchtops	5 years	1 year
Handles	5 years	1 year
Stainless Steel Sink	5 years	1 year
Drying Rack	5 years	1 year
Sink Mixers	10 years	1 year
Hettich Drawer Runners & Door Hinges	Lifetime Warranty	Lifetime Warranty



Head Office:

281 Heads Road, Wanganui
 sales@newtech.co.nz
 06 349 0194 or 0800 728 662

Auckland Concept Showroom:

525 Great South Road, Penrose, Auckland
 Phone: 09 930 6200
 Email: aucklandshowroom@newtech.co.nz

Follow us on



newtech.co.nz



newtech
 BATHROOMWARE DESIGN ■ INNOVATION