

Models: 600mm, 750mm, 900mm (One Drawer)

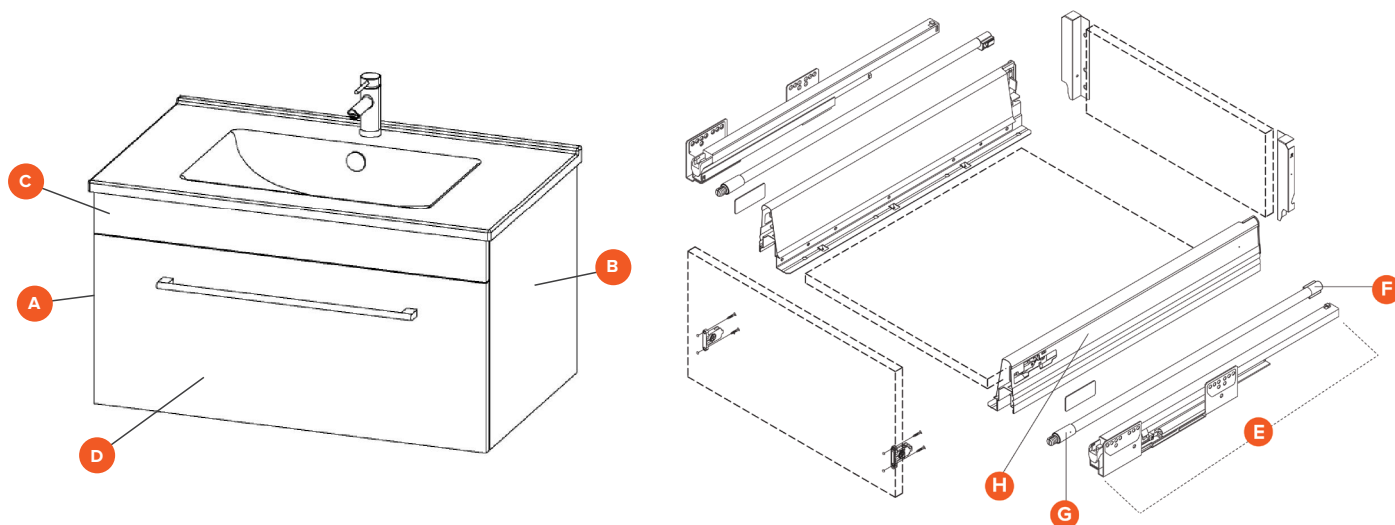

End Panel

Matrix Code	Model to Suit	Newtech Re-order Code
A = Left Hand 400mm x 437mm B = Right Hand 400mm x 437mm	All above models All above models	V1000 V1001

Top Rail

Matrix Code	Model to Suit	Newtech Re-order Code
C = 590mm x 80mm C = 740mm x 80mm C = 890mm x 80mm	600mm cabinet 750mm cabinet 900mm cabinet	V1002 V1010 V1015

Drawer Front

Matrix Code	Model to Suit	Newtech Re-order Code
D = 590mm x 316mm D = 740mm x 316mm D = 890mm x 316mm	600mm cabinet 750mm cabinet 900mm cabinet	V1003 V1050 V1051

Drawer Set

Matrix Code	Model to Suit	Newtech Re-order Code
Complete Drawer Set 400mm	All above models	TDR-400/140

Drawer Runner

Matrix Code	Model to Suit	Newtech Re-order Code
E = Drawer runner - left E = Drawer runner - right	All above models	TDR-400RL TDR-400RR

Gallery Rail including Back Connector

Matrix Code	Model to Suit	Newtech Re-order Code
F (each) - White	All above models	TDR-400GRW

Front Gallery Rail Connector

Matrix Code	Model to Suit	Newtech Re-order Code
G (each)	All above models	TDR-RCF

Drawer Side

Matrix Code	Model to Suit	Newtech Re-order Code
H = Drawer side - left H = Drawer side - right	All above models	TDR-400DSL TDR-400DSR

Models: 600mm, 750mm, 900mm (Double Drawer)

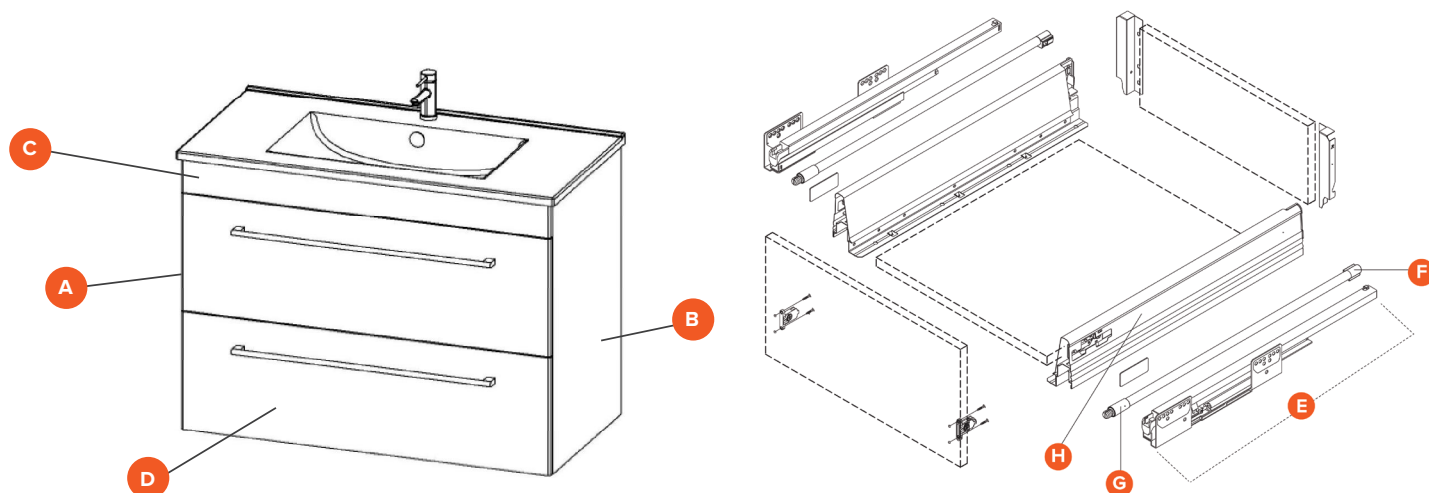

End Panel

Matrix Code	Model to Suit	Newtech Re-order Code
A = Left Hand 437mm x 650mm B = Right Hand 437mm x 650mm	All above models All above models	V1014 V1016

Top Rail

Matrix Code	Model to Suit	Newtech Re-order Code
C = 590mm x 80mm 600mm C = 740mm x 80mm 750mm C = 890mm x 80mm 900mm	600mm 750mm 900mm	V1002 V1010 V1015

Drawer Front

Matrix Code	Model to Suit	Newtech Re-order Code
D = 590mm x 282mm D = 740mm x 282mm D = 890mm x 282mm	600mm 750mm 900mm	V1017 V1018 V1019

Drawer Set

Matrix Code	Model to Suit	Newtech Re-order Code
Complete Drawer Set 400mm	All above models	TDR-400/140

Drawer Runner

Matrix Code	Model to Suit	Newtech Re-order Code
E = Drawer runner - left E = Drawer runner - right	All above models	TDR-400RL TDR-400RR

Back Gallery Rail Connector

Matrix Code	Model to Suit	Newtech Re-order Code
F (each)	All above models	TDR-400GRW

Front Gallery Rail Connector

Matrix Code	Model to Suit	Newtech Re-order Code
G (each)	All above models	TDR-RCF

Drawer Side

Matrix Code	Model to Suit	Newtech Re-order Code
H = Drawer side - left H = Drawer side - right	All above models	TDR-400DSL TDR-400DSR

Models: 1200 Single & Double Basin (Double Drawer) ■ 1500 Double Basin (Double Drawer)

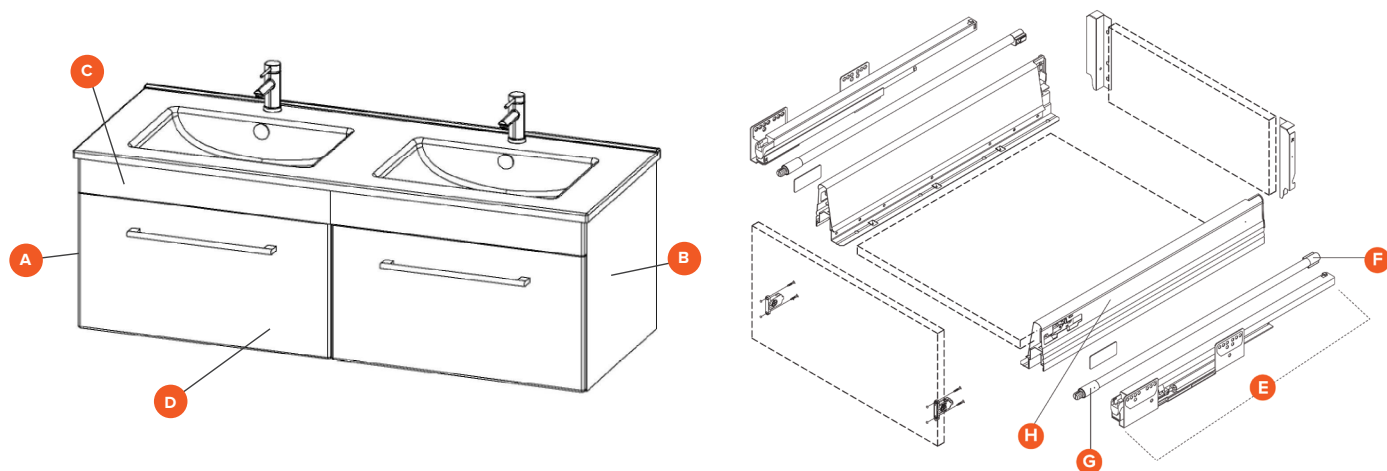

End Panel

Matrix Code	Model to Suit	Newtech Re-order Code
A = Left Hand 400mm x 437mm	All above models	V1000
B = Right Hand 400mm x 437mm	All above models	V1001

Top Rail

Matrix Code	Model to Suit	Newtech Re-order Code
C = 1190mm x 80mm	1200mm single basin cabinet	V1005
C = 1190mm x 80mm	1200mm double basin cabinet	V1004
C = 1190mm x 80mm	1500mm double basin cabinet	V1006

Drawer Front

Matrix Code	Model to Suit	Newtech Re-order Code
D = 594mm x 316mm - left	1200mm single basin cabinet	V1011
D = 594mm x 316mm - right	1200mm single basin cabinet	V1008
D = 594mm x 316mm - left	1200 double basin cabinet	V1012
D = 594mm x 316mm - right	1200 double basin cabinet	V1009
D = 744mm x 316mm - left	1500 double basin cabinet	V1013
D = 744mm x 316mm - right	1500 double basin cabinet	V1007

Drawer Set

Matrix Code	Model to Suit	Newtech Re-order Code
Complete Drawer Set 400mm	All above models	TDR-400/140

Drawer Runner

Matrix Code	Model to Suit	Newtech Re-order Code
E = Drawer runner - left	All above models	TDR-400RL
E = Drawer runner - right		TDR-400RR

Gallery Rail including Back Connector

Matrix Code	Model to Suit	Newtech Re-order Code
F (each) - White	All above models	TDR-400GRW

Front Gallery Rail Connector

Matrix Code	Model to Suit	Newtech Re-order Code
G (each)	All above models	TDR-RCF

Drawer Side

Matrix Code	Model to Suit	Newtech Re-order Code
H = Drawer side - left	All above models	TDR-400DSL
H = Drawer side - right		TDR-400DSR

Models: 1200mm & 1500mm (Four Drawer)

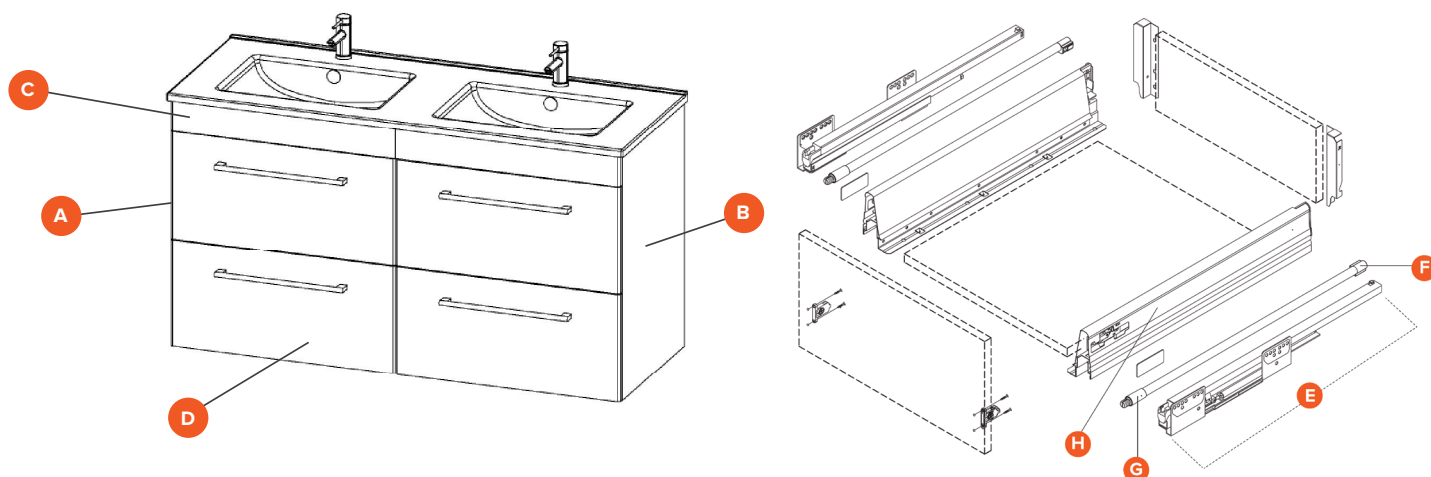

End Panel

Matrix Code	Model to Suit	Newtech Re-order Code
A = Left Hand 437mm x 650mm	All above models	V1014
B = Right Hand 437mm x 650mm	All above models	V1016

Top Rail

Matrix Code	Model to Suit	Newtech Re-order Code
C = 1190mm x 80mm	1200mm single basin cabinet	V1005
C = 1190mm x 80mm	1200mm double basin cabinet	V1004
C = 1490mm x 80mm	1500mm double basin cabinet	V1006

Drawer Front (Left & Right)

Matrix Code	Model to Suit	Newtech Re-order Code
D = Left Hand 594mm x 282mm	1200mm single basin cabinet	V1020
D = Right Hand 594mm x 282mm	1200mm single basin cabinet	V1021
D = Left Hand 594mm x 282mm	1200mm double basin cabinet	V1022
D = Right Hand 594mm x 282mm	1200mm double basin cabinet	V1023
D = Left Hand 744mm x 282mm	1500mm double basin cabinet	V1024
D = Right Hand 744mm x 282mm	1500mm double basin cabinet	V1025

Drawer Set

Matrix Code	Model to Suit	Newtech Re-order Code
Complete Drawer Set 400mm	All above models	TDR-400/140

Drawer Runner

Matrix Code	Model to Suit	Newtech Re-order Code
E = Drawer runner - left	All above models	TDR-400RL
E = Drawer runner - right		TDR-400RR

Back Gallery Rail Connector

Matrix Code	Model to Suit	Newtech Re-order Code
F (each)	All above models	TDR-400GRW

Front Gallery Rail Connector

Matrix Code	Model to Suit	Newtech Re-order Code
G (each)	All above models	TDR-RCF

Drawer Side

Matrix Code	Model to Suit	Newtech Re-order Code
H = Drawer side - left	All above models	TDR-400DSL
H = Drawer side - right		TDR-400DSR

Models: 600mm, 750mm, 900mm (Double Drawer)

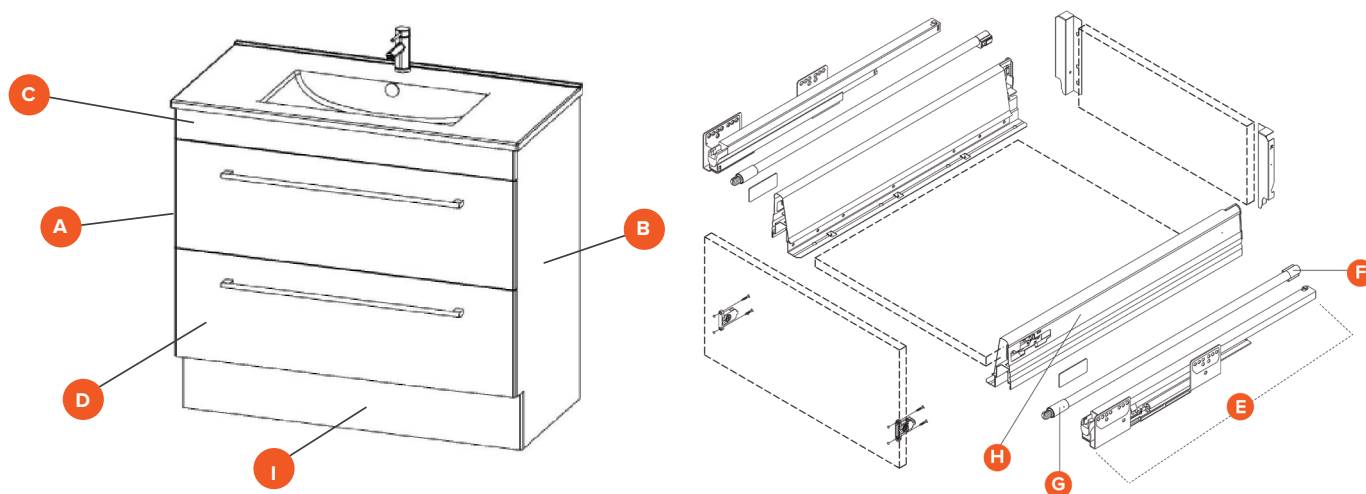

End Panel

Matrix Code	Model to Suit	Newtech Re-order Code
A = Left Hand 437mm x 800mm	All above models	V1026
B = Right Hand 437mm x 800mm	All above models	V1027

Top Rail

Matrix Code	Model to Suit	Newtech Re-order Code
C = 590mm x 80mm	600mm	V1002
C = 740mm x 80mm	750mm	V1010
C = 890mm x 80mm	900mm	V1015

Drawer Front

Matrix Code	Model to Suit	Newtech Re-order Code
D = 590mm x 282mm	600mm	V1017
D = 740mm x 282mm	750mm	V1018
D = 890mm x 282mm	900mm	V1019

Toe-Kick

Matrix Code	Model to Suit	Newtech Re-order Code
I = 590mm x 150mm	600mm	V1028
I = 740mm x 150mm	750mm	V1029
I = 890mm x 150mm	900mm	V1030

Drawer Set

Matrix Code	Model to Suit	Newtech Re-order Code
Complete Drawer Set 400mm	All above models	TDR-400/140

Drawer Runner

Matrix Code	Model to Suit	Newtech Re-order Code
E = Drawer runner - left	All above models	TDR-400RL
E = Drawer runner - right		TDR-400RR

Back Gallery Rail Connector

Matrix Code	Model to Suit	Newtech Re-order Code
F (each)	All above models	TDR-400GRW

Front Gallery Rail Connector

Matrix Code	Model to Suit	Newtech Re-order Code
G (each)	All above models	TDR-RCF

Drawer Side

Matrix Code	Model to Suit	Newtech Re-order Code
H = Drawer side - left	All above models	TDR-400DSL
H = Drawer side - right		TDR-400DSR

Models: 1200mm & 1500mm (Four Drawer)

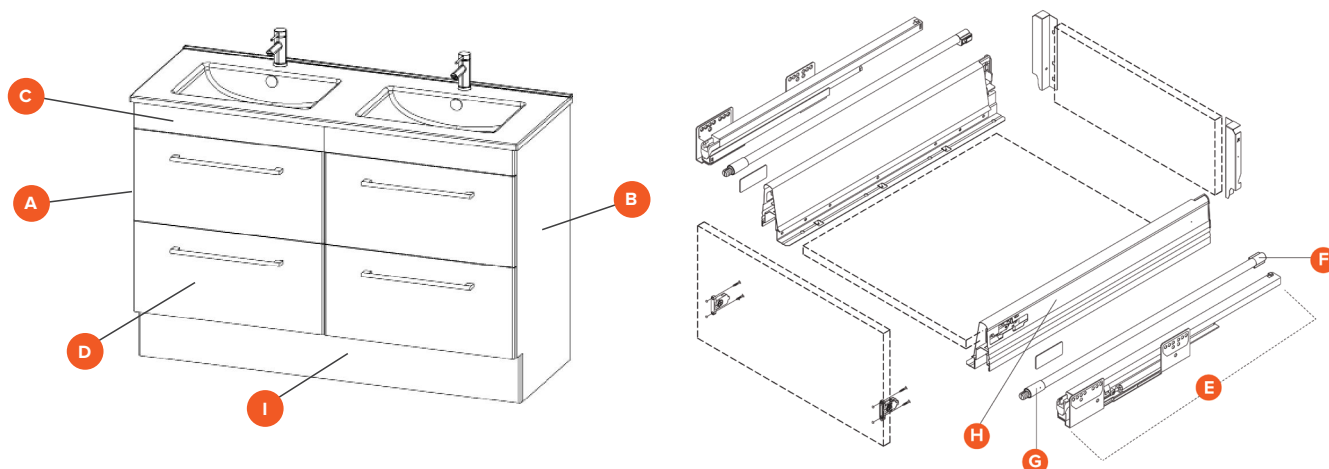

End Panel		
Matrix Code	Model to Suit	Newtech Re-order Code
A = Left Hand 437mm x 800mm	All above models	V1026
B = Right Hand 437mm x 800mm	All above models	V1027
Top Rail		
Matrix Code	Model to Suit	Newtech Re-order Code
C = 1190mm x 80mm	1200mm single basin cabinet	V1005
C = 1190mm x 80mm	1200mm double basin cabinet	V1004
C = 1490mm x 80mm	1500mm double basin cabinet	V1006
Drawer Front (Left & Right)		
Matrix Code	Model to Suit	Newtech Re-order Code
D = Left Hand 594mm x 282mm	1200mm single basin cabinet	V1020
D = Right Hand 594mm x 282mm	1200mm single basin cabinet	V1021
D = Left Hand 594mm x 282mm	1200mm double basin cabinet	V1022
D = Right Hand 594mm x 282mm	1200mm double basin cabinet	V1023
D = Left Hand 744mm x 282mm	1500mm double basin cabinet	V1024
D = Right Hand 744mm x 282mm	1500mm double basin cabinet	V1025
Toe-Kick		
Matrix Code	Model to Suit	Newtech Re-order Code
I = 1190mm x 150mm	1200mm	V1031
I = 1490mm x 150mm	1500mm	V1032
Drawer Set		
Matrix Code	Model to Suit	Newtech Re-order Code
Complete Drawer Set 400mm	All above models	TDR-400/140
Drawer Runner		
Matrix Code	Model to Suit	Newtech Re-order Code
E = Drawer runner - left	All above models	TDR-400RL
E = Drawer runner - right		TDR-400RR
Back Gallery Rail Connector		
Matrix Code	Model to Suit	Newtech Re-order Code
F (each)	All above models	TDR-400GRW
Front Gallery Rail Connector		
Matrix Code	Model to Suit	Newtech Re-order Code
G (each)	All above models	TDR-RCF
Drawer Side		
Matrix Code	Model to Suit	Newtech Re-order Code
H = Drawer side - left	All above models	TDR-400DSL
H = Drawer side - right		TDR-400DSR